

No Drill Front License Plate Bracket Install VW Golf GTI 2022+

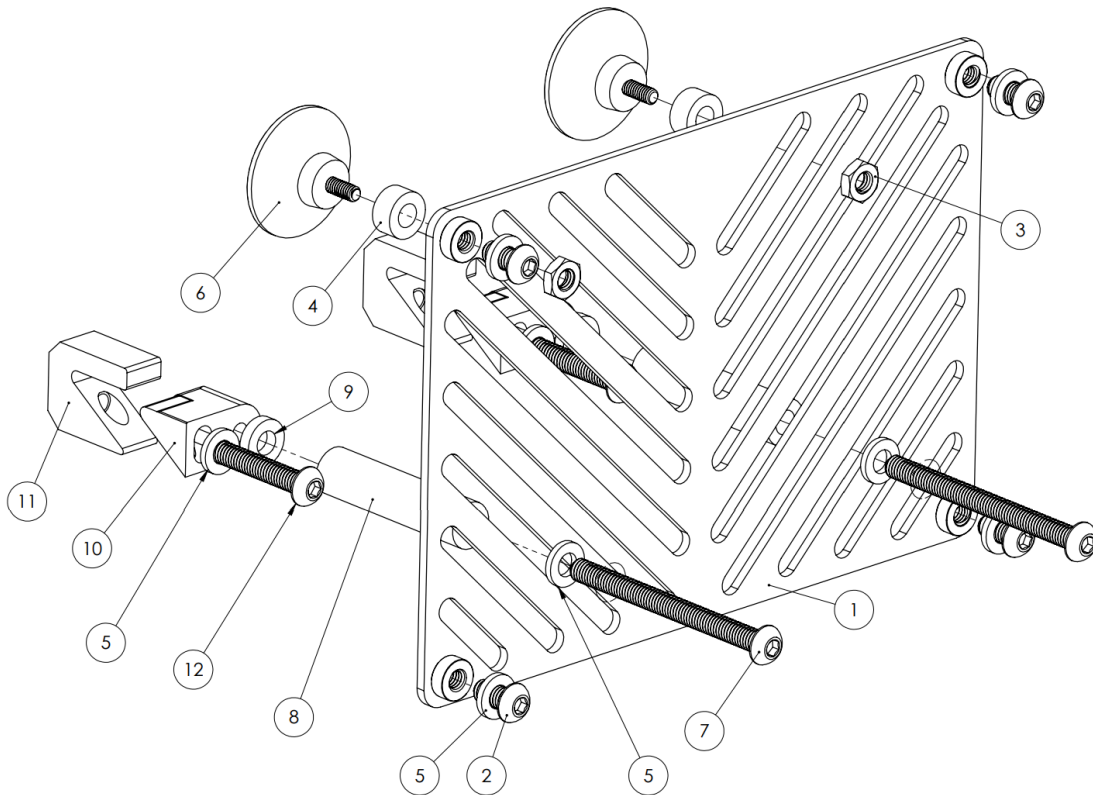

Included Parts:

1. Polycarbonate Plate Bracket
2. M6x12 button head cap screw (4)
3. M6 slot Nut (2)
4. 6mm thick spacer (2)
5. M6 Washer (8)
6. Suction Cup (2)
7. M6 x 40mm button head cap screw (2)
8. 25mm thick spacer (2)
9. 3mm thick spacer
10. Wedge mount (2)
11. Wedge clamp (2)
12. M6x30mm button head cap screws(2)

Install Procedure:

1. The bracket is assembled in the box to help you see how it all goes together. It will require disassembly prior to installation. Assemble the wedge clamps components [10] and [11] using the 30mm long M6 cap screws[12], and M6 washers [5] as shown in the diagram and leave the screws loose allowing the clamp to slide open and closed.
2. Using the Polycarbonate Plate Bracket [1] as a guide, position the wedge clamps in the desired location on the bumper. Usually the top or bottom hex of the grill opening is used and the plate can be offset left or right in the grill. Note that care should be taken to not block the sensors in the front of the bumper. The center location installed at any height should not block the sensor. You should verify this before driving the vehicle.



3. Thoroughly clean the area of the bumper where the suction cup will rest. If installing the plate in a lower position, place the suction cup at one of the “nodes” of the hex for better stability.
4. Feed the Suction Cup [6] through the 6mm thick spacer [4] and through the desired slot from the back side of the Polycarbonate Plate Bracket [1]. Note the suction cups do not need to be “suctioned” down. They are intended to keep the plate from vibrating against the bumper, not hold up the plate.
5. Pass the M6 x 40mm cap screw [7] through the M6 washer [5] then through the desired slot in the Polycarbonate Plate Bracket [1]. Pass the 25mm spacer [8] and 3mm spacer [9], onto the cap screw and thread it into the wedge mount [11].
6. Align and tighten all the cap screws to give the desired position on the bumper. This may take a few tries to get perfectly centered.
7. Fasten the license plate to the Polycarbonate Plate Bracket [1] with the M6x12 Socket Head Cap Screw [2] and M6 Washer [5].