

No Drill Front License Plate Bracket Install VW Golf R 2022+

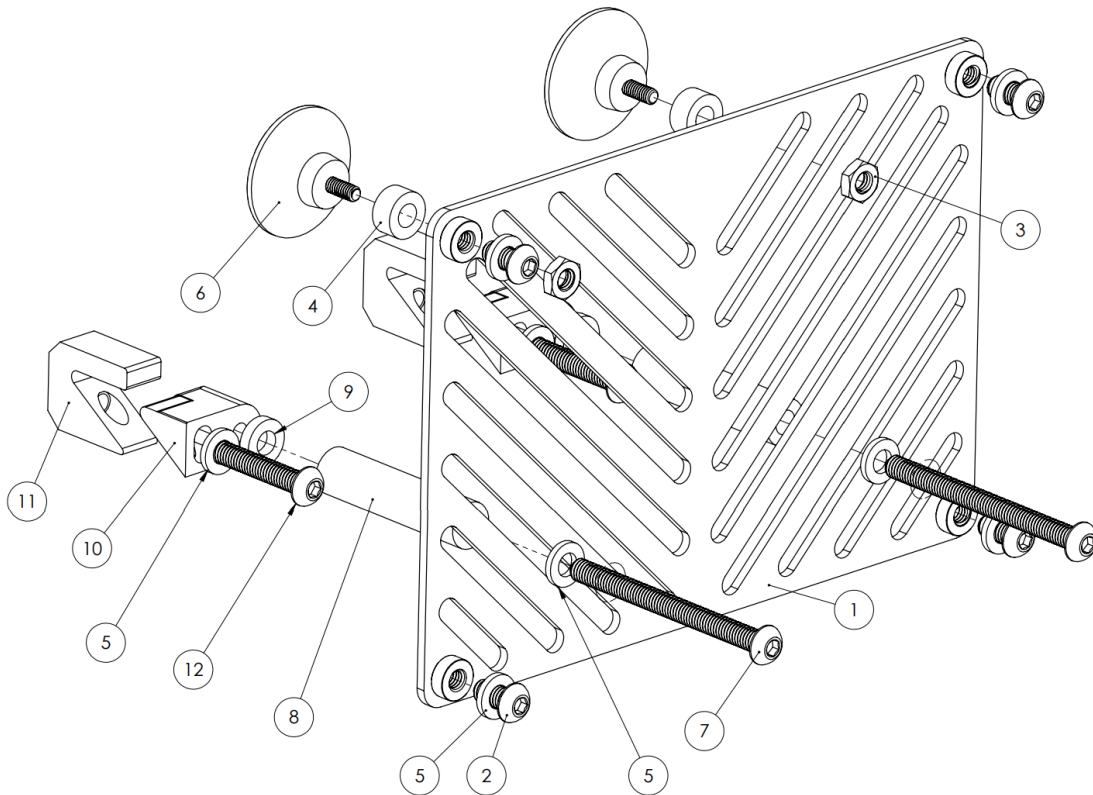

Included Parts:

1. Aluminum Plate Bracket
2. M6x12 button head cap screw (4)
3. M6 Nut (2)
4. 6mm thick spacer (2)
5. M6 Washer (8)
6. Suction Cup (2)
7. M6 x 35mm button head cap screw (2)
8. 25mm thick spacer (2)
9. *Not used for golf R
10. Wedge mount (2)
11. Wedge clamp (2)
12. M6x35mm button head cap screws(2)

Install Procedure:

1. Assemble the wedge clamps components [10] and [11] using the 35mm long M6 cap screws[12], and M6 washers [5] as shown in the diagram and leave the screws loose allowing the clamp to slide open and closed.
2. Using the Aluminum Plate Bracket [1] as a guide, position the wedge clamps in the desired location on the bumper. Usually the top flange of the grill opening is used as well and the plate can be offset left or right in the grill. Note that care should be taken to not block the sensors in the front of the bumper. The center location installed at any height should not block the sensor. You should verify this before driving the vehicle.



3. Thoroughly clean the area of the bumper where the suction cup will rest.
4. Feed the Suction Cup [6] through the 6mm thick spacer [4] and through the desired slot from the back side of the Aluminum Plate Bracket [1]. Note the suction cups do not need to be “suctioned” down. They are intended to keep the plate from vibrating against the bumper, not hold up the plate.
5. Pass the M6 x 35mm cap screw [7] through the M6 washer [5] then through the desired slot in the Aluminum Plate Bracket [1]. Pass the 25mm spacer [8], onto the cap screw and thread it into the wedge mount [11].
6. Align and tighten all the cap screws to give the desired position on the bumper. This may take a few tries to get perfectly centered.
7. Fasten the license plate to the Aluminum Plate Bracket [1] with the M6x12 Socket Head Cap Screw [2] and M6 Washer [5].