

No Drill Front License Plate Bracket Install Acura Integra Type S DE5

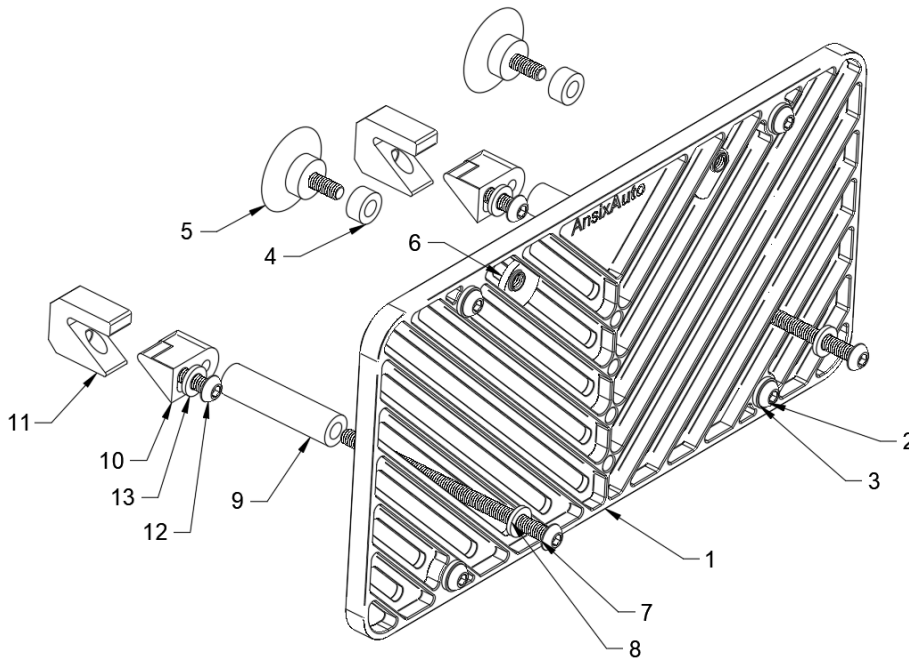

Included Parts:

1. Plate Bracket
2. M6x12 button head cap screw (4)
3. M6 Washer (8)
4. 6mm thick spacer (2)
5. Suction Cup (2)
6. M6 Plate Nut (2)
7. M6 x 30mm button head cap screw (2)
8. M6 Washer (8)
9. Spacer stack [2 x 25mm / 4 x 6mm]
10. Wedge mount (2)
11. Wedge clamp (2)
12. M6x70mm button head cap screws(2)
13. M6 Washer (8)

Install Procedure:

1. Assemble the wedge clamp components [10] and [11] using the 30mm long M6 cap screws [12], and M6 washers [13] as shown in the diagram



2. Clamp the wedge clamp assemblies to the grille. Refer to the above photo for a reference for the positioning.
3. Thoroughly clean the area of the bumper where the suction cup will rest.

4. Feed the Suction Cup [5] through the 6mm thick spacer [4] and through the slot from the back side of the Plate Bracket [1] and into the plate nut [6]. Repeat for both sides. See photo below for a reference for which slot and positioning was used. Note the suction cups do not need to be “suctioned” down. They are intended to keep the plate from vibrating against the bumper, not hold up the plate.



5. Pass the M6 screw [7] through the M6 washer [8] then through the desired slot in the Plate Bracket [1]. Stack the spacers [9] onto the cap screw and thread it into the wedge mounts [10]. For the centered position, use one 25mm spacer and two 6mm spacers for each bolt. For the offset position, use one 25mm spacer and two 6mm spacers for the bolt closer to the center of the car. Use one 25mm spacer and one 6mm spacer for the bolt further from the center of the car.
6. Align and tighten all the cap screws to give the desired position on the bumper. This may take a few tries to get perfectly centered. The position of the wedge clamps may need to be adjusted.
7. Fasten the license plate to the Plate Bracket [1] with the four M6x12 Socket Head Cap Screw [2] and M6 Washer [3].

If desired, you may adjust the position of the license plate by changing the positioning of the clamps and the slot position used on the plate bracket. The license plate can be moved higher or lower or even off to the side depending on your preference. The instructions above provide a starting point on where we recommend the license plate to be positioned.